

ROMANTIC RETRO TOWN MOJIKO

Guide map of Mojiko Retro Town

MOJIKO GUIDE MAP

At these places, tourist information is available.



Mojiko Retro General Information TEL 093-321-4151
 Mojiko Retro Information <http://www.mojiko.info/>

MOJIKO RETRO GUIDE

Mojiko Sightseeing Guide

Glamorous and nostalgic city
Retro City Mojiko
Taking you back to
the good old days



1 関門海峡ミュージアム Kannon Strait Museum
(海峡ミュージアム) (Kaikyo Dramaship)

In the Kannon Strait Museum, opened in 2003, visitors can learn about the past and present of the Kannon Strait using their five senses. The museum offers a number of highlights such as the Strait Aquarium and the Strait History Corridor, which retrace the history of the Kannon Strait, and the Strait Retro Street, which reproduces what Mojiko was like in the Taisho period.

- Hours: 9 am to 5 pm. Closed five days a year.
- Admission: 500 yen (adult) / 200 yen (elementary or junior high school student). 20% discount for groups of 30 or more. ■ Phone: (093) 331-6700

2 門司港駅 JR Mojiko Station



JR Mojiko Station first opened on February 1, 1914. The symmetrical wooden structure was built in the neo-Renaissance style. In 1988, the building became the first railway station designated as a national cultural property.

3 関門海峡らび館 Maritime Affairs Exhibition Hall

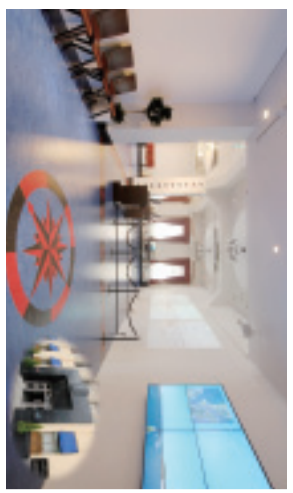

At the Maritime Affairs Exhibition Hall, visitors can view live images of ships passing through the Kannon Strait. Furthermore, visitors can learn about the detailed geological formation and seabed conditions of the Kannon Strait with aerial photos and electronic marine charts.

- Hours: 9 am to 6 pm ■ TEL: (093) 323-5002 ■ Closed 2nd and 4th Thursdays and during year-end and New Year holidays. (December 29 to January 31) ■ Admission: Free



4 九州鉄道記念館 Kyushu Railway History Museum

The former Kyushu Railroad Building was reborn as the Kyushu Railway History Museum. It features real locomotives, railroad cultural heritage exhibits, a driving simulator, a large railway panorama of Kyushu, and a track where visitors can drive a small train.

- Hours: 9 am to 5 pm (admission until 4:30 pm) ■ Closed: 2nd Wednesday in July (closed 2nd Wednesday and Thursday) and August (open 7 days a week)
- Admission: 300 yen (adult) / 150 yen (junior high school age or younger) ■ 20% discount for groups of 30 or more. ■ Phone: (093) 322-1006

5 旧大阪商船 Former O.S.K. Line Bldg.



The octagonal penthouse with its bright orange outer wall is the landmark of the area. This building was constructed as the Moji Branch for Old Mitsui O.S.K. Lines Ltd. Building in 1917. The building has been restored and presently, Seizo Watae Gallery and the Mojiyo Design House are located.

- Hours: 9 am to 5 pm. Open year-round ■ The gallery may be closed due to exhibition change. ■ Admission: Seizo Watae Gallery only: 100 yen (adult) / 50 yen (elementary and junior high school students). 20% discount for groups of 30 or more. ■ Phone: (093) 321-4151

6 旧門司三井倶楽部 Former Moji Mitsui Club



This building was built in 1921 as a place to house important guests. Dr. Eriksen and his wife stayed here during their visit in 1922. There is a restaurant and an event hall on the first floor and memorial rooms for Dr. Eriksen and the famous writer the Fumiko Hayashi on the second floor.

- Hours: 9 am to 5 pm. Open year-round.
- Admission: 100 yen (adult) / 50 yen (elementary or junior high school student). 20% discount for groups of 30 or more. ■ Admission: 1F free ■ Phone: (093) 321-4151

7 海峡プラザ Kaikyo Plaza



The Kaikyo Plaza is a commercial complex. There is a market with a variety of souvenirs, local marine products, and miscellaneous goods. There are also a music box museum and workshop, a glass craft shop and a restaurant that offers a great view.

- Hours: 10 am to 8 pm (shops) / 11 am to 10 pm (restaurant).
- Open year-round. ■ Phone: (093) 332-9121



8 栄町銀天街 Sakaemachi Gintengai

Sakaemachi Gintengai (Shopping Arcade) is spotted with a variety of unique stores and restaurants with a nostalgic atmosphere including Japanese and Western cuisines. It's a port town street with humanity.

9 旧門司税関 Former Moji Customs Bldg.



The Moji Customs was established in 1909. In 1912 this building was constructed and was used as the customs office until early in the Showa period. Now this brick-built, tile-roofed single-story building features a rest area and customs public relations desk on the 1st floor and an art gallery on the 2nd floor.

- Hours: 9 am to 5 pm. Open Year-round
- Admission: Free ■ Phone: (093) 321-4151

10 港ハウス Port House



The Port House is a collection of souvenir shops. The first floor has a market that sells local fresh marine products from Kitakyushu and Shimomoseki, souvenir shops that offer a complete set of Kitakyushu specialties, and a takeout corner.

- Hours: Market: 10 am to 6 pm, souvenir shop: 10 am to 6 pm. Open year-round.
- Phone: (093) 321-6167

A 北九州銀行レトロライン「潮風号」 Kitakyushu Bank Retro-line "Shokaze-go"



Enjoy a relaxing and scenic ride along the coast. Operates weekends and holidays from mid-March to November and during spring vacation, summer vacation, and Golden Week. ■ Hours: 10 am to 5 pm ■ Between Kyushu Railway History Museum Station and Kannon Kaikyo Makari Station ■ Rate: 300 yen (adult) / 150 yen (children) As of March 2017. Contact: Heisei Chikano Railway Co., Ltd. ■ Moji Port Office Phone: (093) 331-1005



11 門司港レトロ展望室 Mojiko Retro Observation Room

The Mojiko Retro Observation Room is located on the 31st floor of the high-rise condominium building "Retro Highpoint" which was designed by leading Japanese architect Kisho Kurokawa. This spacious glass-walked room offers a panoramic view of the Kannon Strait, which changes beautifully morning and evening and season to season.

- Hours: 10 am to 10 pm (admission until 9:30 pm). Café: 10 am to 9 pm (last order: 8:30 pm), closed 4 days a year (on an irregular basis)
- Admission: 300 yen (adult) / 150 yen (elementary or junior high school student). 20% discount for groups of 30 or more ■ Phone: (093) 321-4151

12 国際友好記念図書館 Kitakyushu Commemorative Library of International Friendship



This building, which is a replica of the Chinese Eastern Railway Office that Russia had constructed in Dalian, China, was built in commemoration of the 15th anniversary of the friendship between Kitakyushu and Dalian. There is a restaurant on the first floor, a library with a collection of Chinese and East Asian literature on the second floor, and a reference room on the third floor.

- Hours: 9:30 am to 7 pm (until 6 pm on weekends and holidays) ■ Closed on Mondays (except when Monday is a national holiday) and during year-end and New Year holidays. ■ Admission: Free ■ Phone: (093) 331-5446

13 門司電気通信レトロ館 Moji Telecommunication Museum



This building was constructed as an office building for the Moji Post Office Department of the Communications Ministry in 1924. This was the first modern building in Moji, and still retains the refined modern atmosphere of the Taisho period. On the 1st floor is a booth exhibiting telegraphic communication equipment and telephone sets that were used in the late Taisho and early Showa periods.

- Hours: 9 am to 5 pm (admission until 4:30 pm) (Closed on Mondays (when Monday is a national holiday), closed on the following Tuesday instead), and during year-end and New Year holidays. ■ Admission: Free ■ Phone: (093) 321-1199

B きものソカステーション レトロ着物レンタルステーション Retro Nadeshiko Kimono Rental Station

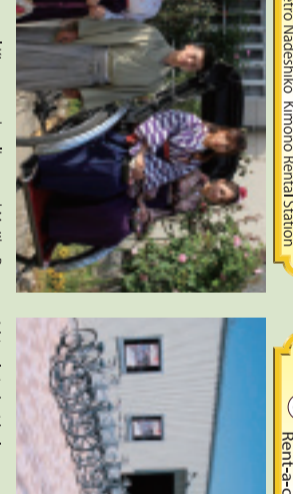

Will you wear rental kimono and walk around Mojiko Retro area? If you choose your favorite kimono and walk around with putting on it, you can enjoy Japanese feeling of 100 years ago.

- Rental fee: 2,000 yen
- Location: Former Moji Customs Bldg.
- Open: May, Jun, Oct, Nov, Dec
- Hours: 10:30 am ~ 4:00 pm



14 出光美術館 (門司) Demitsusu Museum of Arts, Moji

Demitsusu Museum of Arts, Moji is a private museum exhibiting mainly works of art from the personal collection of Sazo Idemitsu, founder of Demitsusu Kosan Co., Ltd.

- Hours: 10 am to 5 pm. Closed on Mondays
- Admission: 700 yen (adult) / 500 yen (high school / university students), and free for elementary / junior high students if they are accompanied by their parents. 200 yen discount for each person in a group of 10 or more. ■ Phone: (093) 322-0251

15 旧大連航路上屋 松永文庫 Former Dalian Sea House Warehouse & Matsunaga Library



Built in 1929, it was originally called the Moji Customs No. 1 Building. In 2013 it was reopened as a recreational facility. The first floor features displays about the cities of Kitakyushu and Dalian (China), and the Matsunaga Library.

- Hours: 9 am to 5 pm daily, closed 4 times per year
- Admission: Free
- Phone: Former Dalian House Terminal (093) 322-5020 Matsunaga Film Museum (093) 331-8013

16 三宜楼 Sankiro



Three-story wooden Japanese-style restaurant "Sankiro" was built in 1931 and is one of the biggest existing Japanese-style restaurants in Kitakyushu. Rebuilt in April 2014, you can enjoy many exhibits which show the prosperity of Moji and the unique cavernous room called "Hyakujyūna".

- Hours: 10 am to 9 pm. Closed on Monday (when Monday is a national holiday), closed on the following Tuesday instead) ■ Admission: Free ■ Phone: (093) 321-2651

D 門司港レトロクルーズ Mojiko Retro Cruise

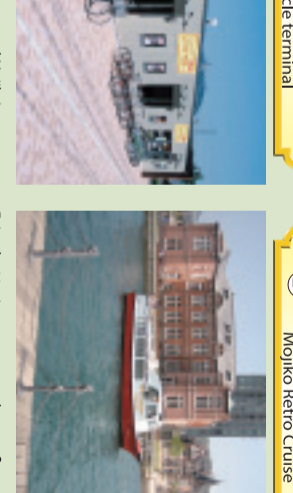

Enjoy the 20 minute tour to see the retro-flavored view of Moji while feeling the sea breeze.

- Fee: 800 yen (adult) / 400 yen (children)
- Contact: Kannon Kisen ■ Phone: (093) 331-4222
- Hours: 11 am to 6 pm (11 am to 6 pm on Saturdays, Sundays and national holidays) ■ Runs every 25 min. (approximately)



17 ノーフォーク広場 Norfolk Square

The grand Kannon Strait spreads right in front of Norfolk Square. This is a popular place to view ships and the Kannon Bridge. The night view of the lit-up bridge is fantastic. This place was named in commemoration of the sister city relationship between Kitakyushu and Norfolk, Virginia, which is on the east coast of the United States.

18 関門トンネル人道 Kannon Pedestrian Tunnel



The Kannon Tunnel, which opened for traffic in 1958, is the world's rare undersea tunnel with a path allowing people to cross under the strait on foot. This tunnel is approximately 780 meters long and it takes about 15 minutes on foot to get to Shimomoseki, the southern end of the main island. The entrance on the Mojiko side is located near Mekari Shrine. People on bicycles can use the tunnel as well.

- Hours: 6 am to 10 pm
- Toll: Free for pedestrians and 20 yen for each bicycle or 50-cc motorcycle

19 和布川第二展望台 Mekari Second Observation Deck



The terrace offers an unparalleled view of the mountains on Kyushu Island and Horiutsu Island, the Kannon Strait between them, and many ships that pass through the strait. Visitors can see a beautiful night view featuring the bridge and the city lights on the opposite shore. There is also a mural of the Daimonryu battle between the Genji and the Heike.

人力車 Rickshaw



Rickshaws are a perfect fit for Mojiko, a romantic city full of the nostalgic atmosphere of the Taisho period. While you are taking a rickshaw, the driver (runner pulling the rickshaw) may tell you good sightseeing spots only known by local residents.

- Fee (approximately): 1 hr.: 3,000 yen for a single passenger 4,000 yen for two passengers
- Reservations and contact: Etsuya Kannon ■ Phone: (093) 332-4444